

### **Our Commitment**

We believe the availability of factory authorized replacement parts is an essential component of customer service. We strive to provide every opportunity for our customers to order and stock factory authorized replacement parts, including special incentive, pricing and freight programs. Contact your Laars representative or sales manager for more details.

### **Ordering**

Laars sells parts only through its normal distribution channels. The most commonly used parts are listed in this parts guide, and can be ordered through Laars stocking representatives or wholesalers. Call the Service Department for assistance in identifying parts not listed. Have the model and serial number of the unit before calling to assure accurate parts identification. Rush Orders: We make every effort to ship rush orders the same day at our regular prices, but cannot guarantee same day shipment. Express freight charged by carriers is not refundable regardless of ship date; please indicate alternate shipping choice if order cannot ship the same day. Some parts are subject to price changes and limited availability. Laars representatives or wholesalers should call the factory for price and lead time for non-current sheet metal parts, parts listed as "limited to stock on hand" and parts not listed in this document.

### **Terms and Conditions**

1. Standard terms will apply to all parts orders.
2. Special pricing is available for bulk quantity orders. Contact the Customer Service Department for pricing and specifics.
3. Expedite fee for non-stocked heat exchangers, 24 hour turnaround \$250.00 net.
4. Expedite fee for non-stocked sheet metal parts (7 working days) is \$250.00 per part.
5. Cancellation fee for custom product already in production: \$250
6. All parts are shipped FOB warehouse.
7. Any excise or sales tax will be charged to and paid by the buyer. Buyer is solely responsible for providing valid resale certificates.

### **Salable Returns / Unused Parts**

Parts in new condition with all original packaging will be considered for return within one year of date of purchase from Laars, subject to a 25% restocking charge *and* recovery of other discounts or incentives earned at time of purchase. Invoice number and date of purchase must be furnished. Refunds will be made to the original purchaser only, and will be made at the sole discretion of Laars. Return of parts may affect eligibility for other programs. Contact your Laars representative for more information.

### **Parts Limited Warranty**

Laars warrants all parts to be free from defects in materials and workmanship to the original retail purchaser for one year from date of retail purchase. Proof of purchase is required. This limited warranty applies only to parts purchased for use as an original equipment replacement part in Laars Heating Systems boilers and water heaters. At its option, Laars will repair or replace any part that fails under this limited warranty. Repair or replacement shall be the sole remedy, and Laars shall not be liable for any field labor, removal, transportation to/from the factory, reinstallation or any other such costs.

### **Return Under Warranty**

Parts should be returned to the place of purchase for warranty evaluation. If the original place of purchase is not known, contact your Laars wholesaler, factory representative or Contract Service Center. Wholesalers, factory representatives and Contract Service Centers returning parts for warranty consideration must obtain a RMA (Return Merchandise Authorization) number from the Customer Service Department. Each part must be tagged with the original purchase date, model and serial number of the boiler it was installed on, and a description of the failure. Parts must be returned freight prepaid and clearly marked with the RMA number. The RMA expires if not returned within 60 days of issuance. Contact your Laars representative or the Customer Service Department for more information on obtaining warranty coverage on large, heavy or bulky items.

Laars Heating Systems maintains a policy of continuous quality improvement.

*Laars Heating Systems Company reserves the right to change specifications, components, features, or to discontinue products without notice. While Laars will make every reasonable effort to provide advance notice of changes, supplier actions, changes in code requirements, and Laars' efforts to continuously upgrade products will sometimes require that changes be introduced with minimal or no advance notice.*

		Part Number		
Description	Model, Size	JVH-50	JVH-75	JVH-100
<b>1. Pilot Gas System</b>				
Pilot Assembly (Nat.), Hot Surface		W2001800	W2001800	W2001800
Pilot Assembly (LP), Hot Surface		W2001900	W2001900	W2001900
<b>2. Burner with Pilot Bracket</b>		L0056500	L0056500	L0056500
<b>3. Main Burner</b>		L0052500	L0052500	L0052500
<b>4. Main Gas Valves</b>				
Valve, Hot Surface, (Nat.) SV9501H 3415		V2001800	V2001800	V2001800
Valve, Hot Surface, (LP) SV9501H 3423		V2002300	V2002300	V2002300
<b>5. Gas Orifices</b>				
(0-2000 FT.) Nat., Orifices		L0032200	L0032200	L0032200
(2001-5000 FT.) Nat., Orifices		L0050700	L0050700	L0050700
(5001-8000 FT.) Nat., Orifices		L0032600	L0032600	L0032600
(8001-10,000 FT.) Nat., Orifices		L0050300	L0050300	L0050300
(0-5000 FT.) LP, Orifices		L0032900	L0032900	L0032900
(5001-8000 FT.) LP, Orifices		L0032800	L0032800	L0032800
(8001-10,000 FT.) LP, Orifices		L0032700	L0032700	L0032700
<b>6. Gas Manifold</b>		L0052601	L0052602	L0052603
<b>Electrical System</b>				
<b>7. Relay, DPNO</b>		E0088400	E0088400	E0088400
<b>8. Transformer 1 1/2 5/24V (50VA)</b>		E2074400	E2074400	E2074400
<b>9. Switch, Air Pressure (0-5000 FT.) Switch, Air Pressure (5001-10000 FT.)</b>		E2074501	E2074501	E2074501
<b>10. Blower/Motor, Induced Draft</b>		A2000200	A2000200	A2000200
<b>11. Switch, Roll-out Safety</b>		E2103200	E2103200	E2103200
<b>12. Switch, Limit</b>		E0098700	E0098700	E0098700
<b>14. Terminal Strip</b>		E0098500	E0098500	E0098500
<b>15. Fuse, 2 amp</b>		E2043600	E2043600	E2043600
<b>Water System</b>				
<b>16. Heat Exchanger</b>		20404701	20404702	20404703
<b>17. Gauge, Temperature/Pressure</b>		A2000400	A2000400	A2000400
<b>18. Gauge, Temperature</b>		A2000600	A2000600	A2000600
<b>19. Valve, Pressure Relief 30 PSI</b>		A0069000	A0069000	A0069000
<b>20. Well, Immersion</b>		E2058300	E2058300	E2058300
<b>21. Valve, Drain 1/2' NPT</b>		P0066600	P0066600	P0066600
<b>Jacket and Fire Box Components</b>				
<b>22. Base Weldment</b>		20400701	20400702	20400703
<b>23. Front Panel Weldment</b>		20404201	20404202	20404203
<b>24. Rear Panel</b>		20403101	20403101	20403102
<b>25. Left Side Panel</b>		20403201	20403201	20403201
<b>26. Right Side Panel</b>		20403202	20403202	20403202
<b>27. Top, Front Section</b>		20404001	20404002	20404003
<b>28. Top, Rear Section</b>		20404101	20404102	20404103
<b>29. Heat Shield, Rear Panel</b>		20403401	20403401	20403402
<b>30. Heat Shield, Front Panel</b>		—	—	—
<b>31. Left Support Rail</b>		20404401	20404401	20404401
<b>32. Right Support Rail</b>		20404402	20404402	20404402
<b>33. Flue Collector Weldment</b>		20403901	20403902	20403903
<b>34. Burner Tray Weldment</b>		20403001	20403002	20403003
<b>35. Control Box Weldment</b>		20086800	20086800	20086800
<b>36. Control Box Cover</b>		20087100	20087100	20087100
<b>37. Burner Cover - A - Sea Level</b>		20403301	20403302	20403303
<b>- B - High Altitude</b>		20404101	20404101	20404101
<b>38. Orifice Plate, Nat. (0-5000 FT.)</b>		20404601	20404603	20404604
<b>Orifice Plate, Nat. (5001-10,000 FT.)</b>		20404602	20404603	20404604
<b>Orifice Plate, LP (0-5000 FT.)</b>		20404601	20404603	20404604
<b>Orifice Plate, LP (5001-10,000 FT.)</b>		20404613	20404602	20404611
<b>39. Tile Cover</b>		10469501	10469502	10469503
<b>40. Heat Exchanger Baffle</b>		10485301	10485302	10485303
<b>41. Front Refractory</b>		T2007701	T2007702	T2007703
<b>42. Rear Refractory</b>		T2007801	T2007802	T2007803
<b>43. Securement Cable</b>		F2007001	F2007002	F2007003
<b>44. Flue Outlet Weldment (0-5000 FT.)</b>		20400400	20400400	20400400
<b>Flue Outlet Weldment (5001-10,000 FT.)</b>		D2004201	D2004201	D2004201

		Part Number		
Description	Model, Size	JVH-125	JVH-160	JVH-225
<b>1. Pilot Gas System</b>				
Pilot Assembly (Nat.), Hot Surface		W2001800	W2001800	W2001800
Pilot Assembly (LP), Hot Surface		W2001900	W2001900	W2001900
<b>2. Burner with Pilot Bracket</b>		L0056500	L0056500	L0056500
<b>3. Main Burner</b>		L0052500	L0052500	L0052500
<b>4. Main Gas Valves</b>				
Valve, Hot Surface, (Nat.) SV9501H315		V2001800	V2001800	
Valve, Hot Surface, (Nat.) SV9601H4601		—	—	V2001900
Valve, Hot Surface, (LP) SV9501H3423		V2002300	V2002300	V2002300
<b>5. Gas Orifices</b>				
(0-2000 FT.) Nat., Orifices		L0032200	L0050700	L0050700
(2001-5000 FT.) Nat., Orifices		L0050700	L0032600	L0032600
(5001-8000 FT.) Nat., Orifices		L0032600	L0050300	L0050300
(8001-10,000 FT.) Nat., Orifices		L0050300	L0050300	L0050300
(0-5000 FT.) LP, Orifices		L0032900	L0032900	L0032900
(5001-8000 FT.) LP, Orifices		L0032800	L0032800	L0032800
(8001-10,000 FT.) LP, Orifices		L0032700	L0032800	L0032800
<b>6. Gas Manifold</b>		L0052604	L0052605	L0052605
<b>Electrical System</b>				
<b>7. Relay, DPNO</b>		E0088400	E0088400	E0088400
<b>8. Transformer</b> 15/24V(50VA)		E2074400	E2074400	E2074400
<b>9. Switch, Air Pressure</b> (0-5000 FT.)		E2074502	E2074502	E2074503
Switch, Air Pressure (5001-10000 FT.)		E2074505	E2074505	E2074506
<b>10. Blower/Motor, Induced Draft</b>		A2000200	A2000200	A2000200
<b>11. Switch, Roll-out Safety</b>		E2103200	E2103200	E2103200
<b>12. Switch, Limit</b>		E0098700	E0098700	E0098700
<b>14. Terminal Strip</b>		E0098500	E0098500	E0098500
<b>15. Fuse, 2 amp</b>		E2043600	E2043600	E2043600
<b>Water System</b>				
<b>16. Heat Exchanger</b>		20404704	20404705	20404706
<b>17. Gauge, Temperature/Pressure</b>		A2000400	A2000400	A2000400
<b>18. Gauge, Temperature</b>		A2000600	A2000600	A2000600
<b>19. Valve, Pressure Relief 30 PSI</b>		A0069000	A0069000	A0069000
<b>20. Well, Immersion</b>		E2058300	E2058300	E2058300
<b>21. Valve, Drain 1/2' NPT</b>		P0066600	P0066600	P0066600
<b>Jacket and Fire Box Components</b>				
<b>22. Base Weldment</b>		20400704	20400705	20400706
<b>23. Front Panel Weldment</b>		20404204	20404205	20404206
<b>24. Rear Panel</b>		20403102	20403103	20403104
<b>25. Left Side Panel</b>		20403201	20403201	20403201
<b>26. Right Side Panel</b>		20403202	20403202	20403202
<b>27. Top, Front Section</b>		20404004	20404005	20404006
<b>28. Top, Rear Section</b>		20404104	20404105	20404106
<b>29. Heat Shield, Rear Panel</b>		20403402	20403403	20403404
<b>30. Heat Shield, Front Panel</b>		20406601	20406602	20406603
<b>31. Left Support Rail</b>		20404401	20404401	20404401
<b>32. Right Support Rail</b>		20404402	20404402	20404402
<b>33. Flue Collector Weldment</b>		20403904	20403905	20403906
<b>34. Burner Tray Weldment</b>		20403004	20403005	20403006
<b>35. Control Box Weldment</b>		20087200	20087200	20087200
<b>36. Control Box Cover</b>		20087100	20087100	20087100
<b>37. Burner Cover</b>		20403304	20403305	20403306
<b>38. Orifice Plate, Nat. (0-5000 FT.)</b>		20404605	20404607	20404609
Orifice Plate, Nat. (5001-10,000 FT.)		20404605	20404606	20404608
Orifice Plate, LP (0-5000 FT.)		20404606	20404608	20404610
Orifice Plate, LP (5001-10,000 FT.)		20404604	20404606	20404612
<b>39. Tile Cover</b>		10469504	10469505	10469506
<b>40. Heat Exchanger Baffle</b>		10485307	10485305	10485306
<b>41. Front Refractory</b>		T2007704	T2007705	T2007706
<b>42. Rear Refractory</b>		T2007804	T2007805	T2007806
<b>43. Securement Cable</b>		F2007004	F2007005	F2007006
<b>44. Flue Outlet Weldment (0-5000 FT.)</b>		20400400	20400400	20400400
Flue Outlet (5001-10,000 FT.)		D2004201	D2004201	D2004201

# Mini-Therm JVi

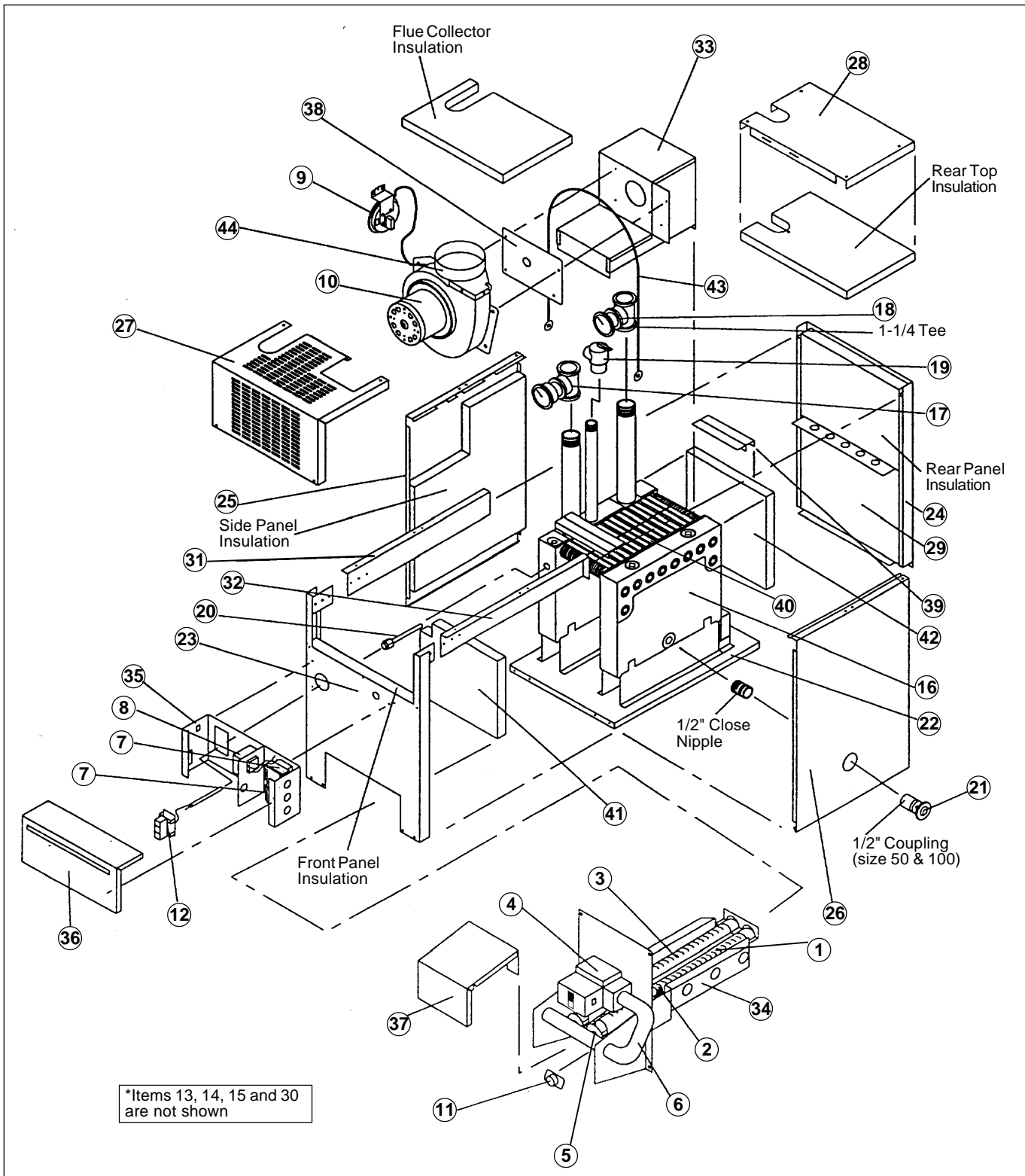

Figure 14. Parts Identification.

Laars Heating Systems Company reserves the right to change specifications, components, features, or to discontinue products without notice.

**LAARS**  
Heating Systems Company  
A subsidiary of BRADFORD WHITE Corporation

800.900.9276 • Fax 800.559.1583 (Customer Service, Service Advisors)

20 Industrial Way, Rochester, NH 03867 • 603.335.6300 • Fax 603.335.3355

1869 Sismet Road, Mississauga, Ontario, Canada L4W 1W8 • 905.238.0100 • Fax 905.366.0130

www.Laars.com

Litho in U.S.A. © Laars Heating Systems 0805 Document 1080D