

G shown with optional leg kit

# Installation

## Laars G Series Tankless Heater Models

LCTEG018, LCTEG025

Voltage options:  
600V Three-Phase  
480V Three-Phase  
415V Three-Phase  
400V Three-Phase  
380V Three-Phase

### Table of Contents

Pre-Installation Information .....	2-3
Storage Instructions .....	3
Mounting Heater .....	4
Plumbing Installation .....	5
Electric Installation .....	6
Start Up Check List .....	7
Start Up .....	8
Digital Controller Operation .....	9
Operational Tests .....	10-11
Product Options .....	11
Maintenance .....	12
Troubleshooting .....	12-13
Special Installation and Operating Instructions .....	14-17

## **DANGER**

Tip over hazard. System can crush you resulting in serious injury or death. Read and follow precautions in this installation manual that accompanied the heater for instructions on how to safely transport and anchor heater. **DO NOT** transport with the heater in the vertical position. This heater is top heavy and should not be placed in the vertical position until the site is prepared to anchor the heater to the wall or the legs to the floor.

## **WARNING**

Read this manual **BEFORE** using this equipment. Failure to read and follow all safety and user information could result in death, serious personal injury, minor burns, property damage, or damage to the equipment. Keep this manual for future reference. Failure to comply with proper installation and maintenance instructions could contribute to the heater's failure.

A qualified plumber or electrician should install and service this system. Install system according to these instructions and in compliance with national and local codes.

ASSE standard 1016, 1069, or 1070 listed devices should be used at fixtures to prevent possible injury. Severe bodily injury including scalding, chilling, and/or death may result depending upon system water pressure changes and/or supply water temperature changes.

For safe operation of the heater, observe all warning labels as indicated.

Water heater system under pressure. **DO NOT** open enclosure while in operation.

These heaters should never be used to provide "anti-scald" or "anti-chill" service.

Hazardous voltage inside enclosure may result in serious burns or death. Disconnect power supply before performing any work in the enclosure.

Failure to ground this system may result in death or serious injury.

Make sure that all water supply lines have been flushed and then completely turned off before beginning installation.

Debris in supply lines can cause valves to malfunction.

## **CAUTION**

Hot pipes! **DO NOT** touch. May cause minor burns.

## **NOTICE**

These heaters **DO NOT** provide protection from supply or outlet pipe freezing.

Consult local building and plumbing codes prior to installation. Should these codes differ from the information in the manual, follow the local codes. Inquire with governing authorities for additional local requirements.

Regular checking and cleaning of the heater's internal components and check stops is necessary for maximum life and proper product function. Periodic inspection and yearly maintenance by a licensed contractor is required. Corrosive water conditions, and/or unauthorized adjustments or repairs could render the heater ineffective for its intended service. Frequency of cleaning and inspection depends upon local water conditions. For heaters with adjustable output temperatures, check and adjust as needed at initial installation and on a quarterly basis.

## **IMPORTANT**

Read this entire installation manual to ensure proper installation. When finished with the installation, file this manual with the owner or maintenance department. Compliance and conformity to local codes and ordinances is the responsibility of the installer. Product warranties may be found under "Resources" on our website at [www.laars.com](http://www.laars.com).

Separate parts from packaging and make sure all parts are accounted for before discarding any packaging material. If any parts are missing, do not begin installation until you obtain the missing parts.

## Pre-Installation Information

### General Information

The G Series Tankless Water Heater provides instant and precise temperature-controlled hot water. To ensure proper performance, install the heater according to the following installation instructions and in compliance with applicable national and local codes.

Flow rates and temperature figures are important for proper sizing. If needed to meet certain temperature demands, flow control devices are readily available. See Temperature Rise Specifications chart. Contact Laars representatives for further information on available flow devices.

### Operation and Setup

G Series heaters supply an unlimited amount of hot water with specific flow and temperature rise capabilities. These heaters are energy efficient, reliable, and provide optimum performance in the most demanding applications.

### Application Specific Requirements

The G Series can be used in many different applications that require custom tuning for specific applications to maximize performance of the heater.

For use in a re-circulation loop, the incoming loop temperature should not exceed 140°F (60°C).

For applications utilizing quick close valves or solenoid valves, it is important to install a hammer arrestor or surge tank close to the point of use to absorb pressure spikes.

### Installation Considerations

Maximum operating pressure: 150 psi (10 bar)

Standard flow activation: 0.75 gpm (2.8 lpm)

### Certifications

Certified by ETL to UL499, UL50E, CSA22.2 No. 88 and NFPA 496 (for hazardous locations) and third party certified to NSF/ANSI 372. Heaters are compliant with NEC/NFPA 70 and Canadian Electrical Code C22.1.

 **WARNING** For safe operation of the heater, observe all the warning labels as indicated.

## Storage Instructions

**NOTICE!** *Keep Electric Tankless Water Heaters stored in original packaging until installation.*

### Recommended storage criteria:

Store Electric Tankless Water Heaters where temperatures exceed 35°F (2°C) at all times.

Indoor storage is recommended.

Minimize excessive on-site transport to reduce risk of shock and impact damage.

### Alternate storage:

If in the original crate, Electric Tankless Water Heaters will withstand outside storage for approximately 1 month in most climates. The crate may not be capable of protecting the heater if left outside longer than this time frame.

If the Electric Tankless Water Heater is stored in an outdoor environment, care should be taken to protect the heaters from:

- Rain or other falling precipitation via tarp or other waterproof media
- Runoff and accumulation of groundwater from any source that may exceed 1 inch (25mm).

## Packaging

Crates are constructed from 3/4" (19mm) OSB.

Crate dimensions approx: 44" x 28" x 12" (1118mm x 711mm x 305mm)

Crates should not be stacked more than 2 high.

All crates must be stacked evenly and horizontally.

Safety issues related to packaging:

- Product should be transported with the care associated to packages labeled "FRAGILE" even if packaging is not marked accordingly marked accordingly.
- Standard safety procedures for forklift transport and large items less than 1000lbs (454 kgs) should be followed at all times.
- When stored, crate must be supported in entirety of its length and width.

## 1 Mounting Heater



**WARNING HIGH VOLTAGE SHOCK. Disconnect power supply before performing any work inside the heater enclosure.**



*Installation should be performed by a qualified plumber or electrician.*



*For best results, install heater as close as possible to the point of use.*



*Long pipe runs are not recommended. A heat loss of 1°F for every 10ft (3 meters) of uninsulated pipe can occur.*



*When determining a mounting location, give consideration to the location of the main electrical panel and ensure accessibility of the cabinet enclosure door and other plumbing for service/maintenance. 36" (914mm) minimum in front of cabinet enclosure is required.*



Set heater in a vertical, upright position with the water outlet located at top.

### Standard Wall Mount

Mount heater to the wall using the (4) mounting brackets on the back of the enclosure brackets on the back of the enclosure heater to the vertical surface heater to the vertical surface must support 150 lbs or more.



### Optional Leg Kit

Use the floor mounting template on the side of the crate to help with alignment side of the crate to help with alignment.

Secure heater by bolting each leg to the floor using 3/8" (10mm) anchor bolts.

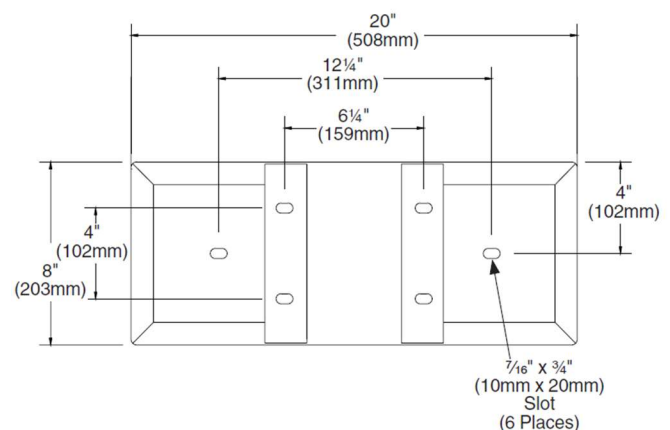

Install the pressure and temperature relief valve on hot water outlet immediately following the union.

**NOTICE! Valve must empty into a drain.**



*Rectangle outlines on template are not actual size of heater.*



*Template may require cutting to fit into tight areas.*



*Holes are for alignment purposes and may not represent actual drill size for mounting hardware.*

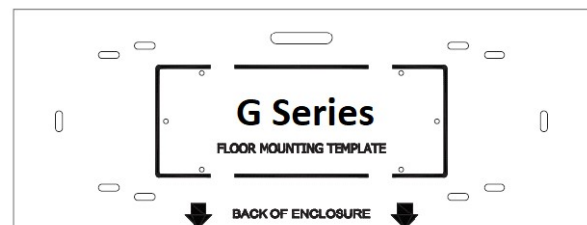

2

Plumbing Installation

Components Needed:

- (2) Union 3/4"
- Shutoff Valve
- Pressure and Temperature Relief Valve (150 psi/10 bar)
- Y-Strainer (100 mesh) or Inline Filter (150 microns)
- (2) Gate or Ball Type Valves
- Drain pipe
- Water hammer arrestor (recommended)
- Elbows, nipples and fittings as needed

**CAUTION** To avoid damage to the electronics or internal wiring, do not perform any brazing or sweat soldering inside the enclosure.

**NOTICE!** Failure to install proper filtration may result in a flow switch malfunction.

**NOTICE!** To avoid water damage, install a drain pipe from the pressure relief valve to an unrestricted drain.



If end use fixture is not at the highest point in the plumbing loop, then an automatic air vent valve must be added at the highest point in the system or at any drop to eliminate trapped air.

**A** Install shutoff valve above (upstream of) the heater inlet.

**B**

Install one union on the water inlet side of the heater. Install one 100 Mesh (150 micron) Y-strainer above (upstream of) union.

Install one union on the water outlet side of the heater. Install one T & P Relief Valve above (downstream of) union.

Install the pressure relief valve (150 psi/10 bar) and outlet plumbing of heater per code requirements and route relief valve discharge to drain. Make sure no shutoff valve is between the water heater outlet and the relief valve, as well as no shutoff valve between the relief valve discharge and drain. Install hammer arrestor. Ensure plumbing is secure and not subject to vibrations.

**C** Use 3/4" hard copper tubing or pipe as needed.

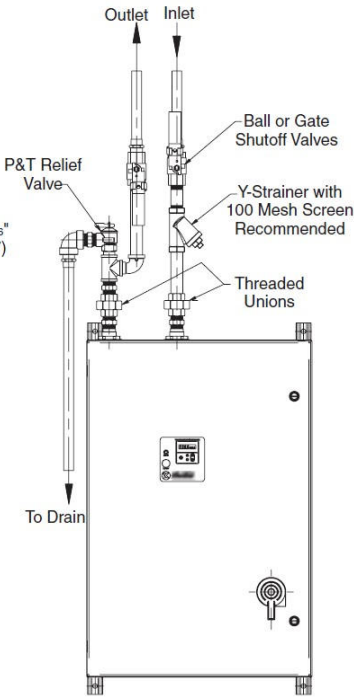
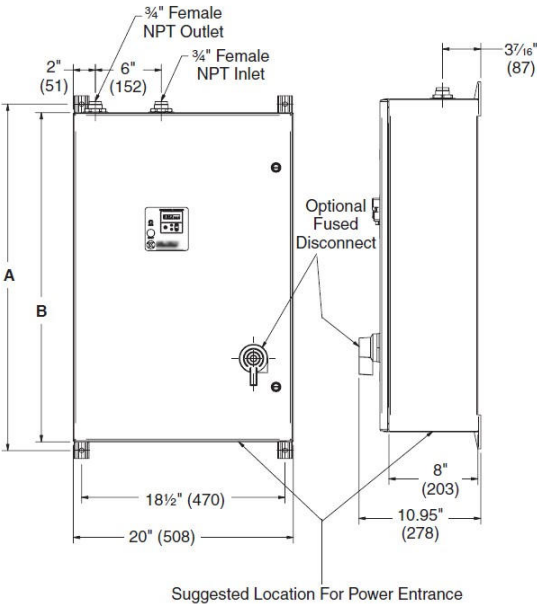

	Dim. "A"	Dim. "B"
18kW	31-1/2" (800mm)	30" (762mm)
25kW	37-1/2" (953mm)	36" (914mm)

Dimensions, Plumbing and Electrical Configurations



**Suggested Installation Configuration**  
Components provided by installer unless otherwise specified. Reference the product options sections or contact your local Laars representative for product options.

### 3 Electric Installation

-  **WARNING** Install product to rated line voltage in accordance to current local and national codes and regulations.
-  **WARNING** All heaters must be fused in accordance with National Electric Code (NEC) for the full load amperage listed on the nameplate rating for each heater.
-  **WARNING** Failure to properly ground the unit(s) per the National Electric Code could result in injury or death.

**A** Open enclosure door.

**NOTICE!** Any option that requires field wiring must be done with 600V cable per the schematic that was shipped with the heater.

**NOTICE!** Use a 4-core cable or multi-stranded machine tool wire from an approved isolating 3-pole switch or circuit breaker.

**NOTICE!** Make sure the electrical cable is the correct size to carry 100% of the full load current. See table for proper wire sizes.

**B** Using a hole punch, cut a hole the proper size for conduit connection large enough for the wire size for each heater. The connectors need to be rated NEMA4/4X to ensure proper sealing of the enclosure.

**C** Run wires through the appropriate size conduit.

**D** Connect wires to the system terminal block or fused disconnect inside the enclosure.

**E** Connect the ground wire to the stud provided with the "Ground" label beneath it.

#### ELECTRICAL SPECIFICATIONS FOR HEATER (3-PHASE)

Model	Voltage	Amps	kWatts	Min Wire Size
CTEG018T	600	18	18	10 AWG*
CTEG025T	600	24	25	10 AWG*
CTEG018S	480	22	18	10 AWG*
CTEG025S	480	30	25	8 AWG*
CTEG018P	415	18	13	10 AWG*
CTEG025P	415	26	19	8 AWG*
CTEG018N	400	17	12	12 AWG*
CTEG025N	400	24	17	10 AWG*
CTEG018M	380	17	11	12 AWG*
CTEG025M	380	24	15	10 AWG*

\* Based on the NEC Table 310.15 for 75°C insulated copper wire @30°C Ambient. Aluminum wire requires larger gauges.



Not all available (optional) voltages are listed in table.

## **4 Start Up Check List**

### **Plumbing**

- ☐ System is set in a vertical, level, and upright position with the outlet located at the top. System is mounted to the wall using the (4) mounting brackets on the back of the enclosure or bolted to the floor with the optional leg kit.
- ☐ Confirm installation of shutoff valve above (upstream of) the union on the inlet connection Confirm installation of a Y-strainer (100 mesh screen) or inline filter (150 micron) between the inlet shutoff valve and the heater.
- ☐ Pressure and temperature relief valve is installed on tepid water outlet immediately following the union No valve or restriction is between the relief valve and the system or the relief valve and drain Shutoff valve is installed after pressure and temperature relief valve on outlet if required by local or national plumbing codes.
- ☐ If the hot water process is not at the highest point in the plumbing loop, then an automatic air vent valve must be added at the highest point in the system plumbing loop to eliminate trapped air.

### **Electrical**

- ☐ Verify supply voltage matches the indicated voltage on the Serial Tag. Serial Tag is located within the heater enclosure on the upper left corner of the back plate (mounting plate).
- ☐ Appropriate conduit is installed properly, secured and sealed to unit enclosure per NEC and hazard location requirements.
- ☐ Appropriate conductors for unit routed through conduit and secured to power block inside the enclosure All electrical is installed in accordance with national and local electrical codes, including fuse size and rating.
- ☐ Appropriate earth ground is installed to the lug provided on enclosure backplate.

## 5 Start Up



**WARNING** Make sure the circuit breaker for the heater is OFF.



Be sure that plumbing and electrical are complete per Start Up Check List.

**A**

Slowly turn on water supply to the unit with the enclosure door open and the circuit breaker in the off position.

**F**

Energize the electrical service to the unit by switching on the circuit breaker.

**B**

Slowly turn on the water outlet valve, activate the connected process requiring heated water (faucet, shower, etc.), then flush the system for 5 minutes to ensure all air is purged from the system.

**NOTICE!** Failure to bleed air properly will damage elements and cause heater malfunction.

**G**

Unit is now in the ready state.

**H**

Turn on the connected process; observe output temperature rise to setpoint.



Top portion of temperature controller displays output temperature, bottom displays setpoint temperature.

**C**

Turn off the connected process and check the entire system to verify leak-free installation.

**I**

When startup is complete, leave circuit breaker in the ON position. The green power light should be illuminated.

**D**

Close enclosure door and secure.

**E**

If your heater has the EXP2 option and is located in a Class I Division 2 area, please review Special Instructions & Operation Instructions section for all proper electrical connections and sealing to ensure the installation will provide the proper protection. Proceed to Step F once you have completed the steps in the Special Instructions & Operation Instructions or if you do not have this option.

## 6 Digital Controller Operation



The preprogrammed digital controller is mounted through the bezel on the enclosure door. The digital controller will be powered but the bottom display will read OFF until water is flowing through the heater. The bottom display will then display the setpoint temperature (see Digital Controller Operation section for more information).



Refer to table and drawings below for instructions on changing the desired set point temperature of the controller.

Description	Upper Display	Lower Display	Function
EZ Key			Toggles output on/off
Setpoint Up Button			Increases output temperature
Setpoint Down Button			Decreases output temperature
Infinity Key			Back to Home page
Advance Key			Advances through parameter prompts
	Auto, Man, Off	C.r71	Turns Control Loop On/Manual/Off
	XX.X%	h.PR1	Heater Power%
	No	AU1	Autotune (Contact Laars Representative)
	C or F	C_F1	Change Temperature Units from F to C
Output Indicators (1-5)			Output 1, 2, 3, 4 or 5 are active and operating if these LEDs are illuminated.
Setpoint Temperature (Lower Display)			Displays: <ul style="list-style-type: none"> <li>Setpoint</li> <li>Percent Power</li> <li>Temperature units F or C</li> <li>Menu prompt name</li> <li>Alarm code</li> </ul>
Output Temperature (Upper Display)			Displays: <ul style="list-style-type: none"> <li>Actual process temp. of outgoing water</li> <li>Prompt parameter value</li> <li>Error code (feature disabled)</li> </ul>

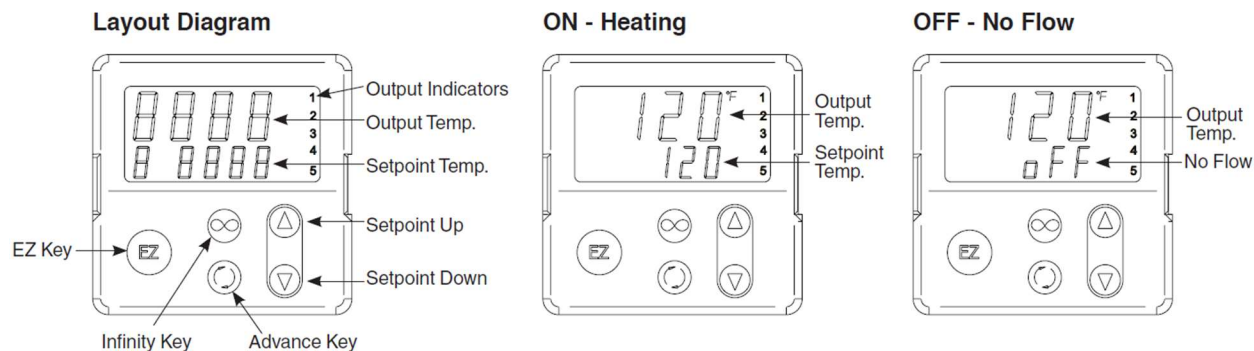

## 7 Perform Operational Test No. 1



Ensure the enclosure door is closed prior to performing operation test.

**A**

Set the 3-pole switch or circuit breaker to the ON position.

**B**

Start the water flow through the heater by starting the process or fixture this heater is connected to in order to activate heater.

**C**

When flow rate reaches approximately 0.75gpm/ 2.8 lpm (standard), the flow switch activates and begins the heating process.

**When the flow switch activates:**

- Element load indicator lights illuminate on the front bezel verifying power supply connection to the heating elements via the solid-state relays.
- Element load lights may be solid or flash in unison as heating elements modulate depending on the hot water demand.
- Lower display on controller goes from off to setpoint temperature.

**D**

Press the up or down arrow keys to adjust the set temperature. The controller displays the temperature of water measured at the outlet.



*Located on the panel is one 18kW or 25kW green ready light. When illuminated, the safety circuit is engaged and ready for use.*

**E**

Test water temperature and stability at outlet by viewing the display (in red) the temperature of water exiting the heater.



*Heater will not energize heating elements if the inlet water temperature is equal to or greater than the temperature set on the digital controller.*

## 8 Perform Operational Test No. 2



*Each model has precise specifications for temperature rise capabilities.*

**A**

Turn on hot water faucet/fixture/process. The heater should activate immediately.

**B**

Turn off hot water faucet/fixture/process. The flow switch will deactivate and shut off power to the heater.



*If the water flow exceeds maximum heating capacity of the heater, the temperature of water at the outlet may be lower than the temperature selected on the controller. See table below to determine maximum temperature rise capabilities.*

**Temperature Rise (GPM & F°)**

480/600V	kW	1 gpm ΔT °F	2 gpm ΔT °F	3 gpm ΔT °F	4 gpm ΔT °F	5 gpm ΔT °F	6 gpm ΔT °F	7 gpm ΔT °F	8 gpm ΔT °F	9 gpm ΔT °F	10 gpm ΔT °F
LCTEG018	18	122	61	41	31	25	20	17	15	13	12
LCTEG025	25	160*	85	57	43	34	28	24	21	19	17

\*May exceed the maximum temperature setting of the heater

**Temperature Rise (lpm & C°)**

480/600V	kW	3.8 lpm ΔT °C	7.6 lpm ΔT °C	11.4 lpm ΔT °C	15.1 lpm ΔT °C	18.9 lpm ΔT °C	22.7 lpm ΔT °C	26.5 lpm ΔT °C	30.2 lpm ΔT °C	34.1 lpm ΔT °C	37.8 lpm ΔT °C
LCTEG018	18	68	34	23	17	14	11	9	8	7	7
LCTEG025	25	89	47	32	24	19	16	13	12	11	9

Output heating capacity is reduced if these heaters are installed on 415V, 400V, or 380V 3-ph. Contact a Laars representative to supply this information.

Satisfactory performance of the heater is dependent upon a specific flow rate vs temperature rise capability. If the desired temperature is not achieved, please verify the following:

1. Circuit breaker is on and rated for the maximum power draw.
2. Heater is drawing the proper current for the supply voltage on all three phases.
3. All element load indicator lights are lit (not flashing) indicating maximum power draw and maximum amperage is being drawn.
4. Flow rate and temperature rise in the water heating process are compatible with the heater specifications. Verify there is no additional supply of cold water entering the line downstream of the heater.

## Product Options

**GF (Ground Fault):** Detects electrical leakage from external sources to protect equipment, electronics, and the heat exchanger from being damaged in the event of a power fault. After turning on water, then power, test ground fault:

1. Press GF Test button.
2. Watch for ground fault light to illuminate and Bank Ready light(s) to shut off. The Ground Fault system is active and in working order.
3. Press the GF Reset button, hold for 2 seconds and release to reset ground fault.

NOTE: If a trip occurs under normal operation DO NOT RESET Ground Fault without evaluation and service.

NOTE: Normal state is Ground Fault light OFF, Bank Ready lights ON.

**FDS Fused Disconnect:** Internal fused disconnect interlocks with enclosure door when energized, prohibiting access to a live cabinet. Select the FDS option for an additional level of safety and convenience at the heater location.

**T170, T180, T190 & T200 High Temperature Option:** High temperatures as indicated (maximum of 170°F/76.7°C, 180°F/82.2°C, 190°F/87.8°C, 200°F/93.3°C).

**D1 Control Interface:** Provides 4–20ma communication interface with temperature controller.

**TE & TE2 Corrosive Fluid Protection:** The TE option is a PFA Teflon<sup>®</sup> coated heat exchanger with bright annealed stainless steel elements, FDA Approved (use for deionized water or mild corrosive fluid applications). Similar to TE, the TE2 option is a single layer of Xylan Fluoropolymeric coated heat exchanger with bright annealed stainless steel elements, FDA Approved for Food Contact (use in deionized water applications).

**EXP2 (Explosion Proof Purge System):** EXP2 option makes heaters compliant for classified areas; Class L Division 2, Groups A, B, C, D, Temp Code: T5. The Purge System requires a supply of clean instrument air or inert gas (provided by installer). This supply maintains a positive internal pressure and prevents the enclosure from filling with flammable gases, dusts, or vapors from the ambient environment. Complete installation provided in this manual.

**Low Flow (L25 & L5):** Options include 0.25 GPM (1.0 lpm) and 0.50 GPM (1.9 lpm) for heating water when lower flow rates are required.

**AL High-Low Temperature Alarm:** Alerts user to an over or under temperature situation.

**DC Control Interface:** Is an RS-485 Modbus RTU and allows Building Management Systems to view heater outlet temperature and heater activation via BMS display as well as change the temperature set-point from the BMS.

**N4X & N4X316 Cabinet Enclosure:** NEMA 4X corrosion resistant enclosure made of stainless steel (316 stainless steel for N4X316 option) and ideal for harsh environments.

**LK:** Leg kit converts the heater from a wall-mounted unit to a floor-mounted unit.

## Maintenance

Preventative maintenance is important for optimal performance of the heater. To ensure the heater works properly, always keep the inside of the enclosure dry. Moisture inside an enclosure increases the humidity, which condenses on cooler surfaces. This can cause electrical problems and reduce the efficiency of enclosure insulation. To prevent problems, perform the following:

- Verify the interior of the enclosure is dry.
- Verify there are no leaks in seals of enclosure and that in high humidity environments all enclosure egresses are properly sealed.
- Ensure plugs are in place on back side of enclosure.
- Check seals monthly during temperatures above 32°F (0°C) and weekly during temperatures below 32°F (0°C).
- Bimetal manual reset safeties are set to trip at 175°F (79°C). If this temperature is reached, the bimetal manual safeties will trip and need to be reset.
- All heaters require filtration of 150 microns or smaller to ensure proper operation. Y-strainers or additional filtration should be verified and cleaned at least every 6 months or more often in areas where hard water sediment is present in the water.

To clean the Y-Strainer:

1. Turn the power off at the circuit breaker panel.
  2. Shut off the installer supplied cold water isolation valve to the heater.
  3. Relieve pressure in the plumbing lines.
  4. Position a bucket under the cold water inlet to catch any water that may still be in the pipe.
  5. Loosen the plumbing connection on the Y-strainer to get to the screen.
  6. Remove screen and clean out debris. Use a wire brush to clean smaller particles from the screen.
  7. Once the screen is clean, put it back into the Y-strainer housing and secure the plumbing connection.
  8. Before switching the power back on, bleed the air out of the lines by turning heater water supply back on and the plumbing fixture or process farthest from the heater.
  9. With the air purged, turn on all circuit breakers supplying the water heater.
- At the same time the Y-strainer or additional filtration is cleaned, it is a good practice to also check all valves connected to the system. With no water flow through the heater, work both the inlet ball valves and the outlet gate valves open and shut to break up any calcium deposits that may have formed from the valve being open for an extended period of time. Power to the heater does not need to be turned off to do this.

## Troubleshooting for Controller

Problem	Solution
No Power	Verify power is on.
	Check incoming service connection. Voltage must match name plate rated voltage. Labels are located on upper left of back plate (serial number label).
	Turn power off. Check continuity of all internal fuses in control transformer, heating elements or optional fused disconnect circuits.
	Check all field service circuit breakers or fuses.
	Check the safety interlock door switch to make sure that lack of power is not due to mis-adjustment or open enclosure door.
	Check system temperature limit control to make sure it has not activated due to excessive heat exchanger temperature or faulty sensor.
	Turn power off. Check for loose or disconnected wires.

## Basic Troubleshooting

Problem	Solution
The heater does not work or works intermittently.	<ol style="list-style-type: none"> <li>1. Heater is wired with the proper breaker and wire size. Refer to Electrical Specifications table in Step 3 for proper requirements.</li> <li>2. Unit is receiving voltage from all three phases of the power source. A load voltage reading is also helpful.</li> <li>3. Verify the functionality of the flow switch.</li> <li>4. At the wires from the flow switch, read "Open" without flow and "Closed" with flow.</li> <li>5. Water flow through the heater is adequate to activate the flow switch at 0 .75gpm/2 .8 lpm (standard).</li> </ol>

**IMPORTANT: Turn power OFF before recording any Ohm readings.**

**If the above steps do not solve the problem, some additional checks may be performed. Follow the schematic to perform the following continuity checks:**

- ☐ High temperature bimetals (Manual Reset Safeties).
- ☐ Optional ground fault breaker must be in the closed position for the unit to work.
- ☐ All internal breakers must be in the ON position for the unit to work.

For additional information on Troubleshooting or other information, contact Laars Technical Support. Please have Model No. and Serial No. available when seeking technical assistance. Serial No. tag is located in the enclosure on the upper left hand corner of the back plate.

**Please record and maintain this information at all times:**

**G Series Model No.** \_\_\_\_\_

**Serial No.** \_\_\_\_\_

## Special Installation and Operating Instructions

### Tankless Water Heaters With Optional Class I Division 2 Purge EXP2 Option

#### General Information

All Tankless Water Heaters with EXP2 have been fitted with a Z purge system to pressurize the enclosure suitable for use in Class I Division 2 Hazardous Locations.

A Continuous Flow (Model CF) Mini-Z Pressurizing System has been fitted to the bottom of the enclosure.

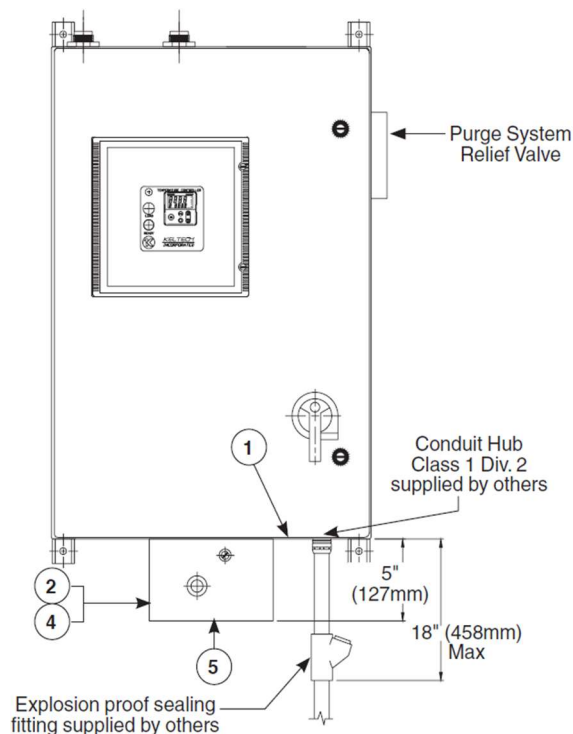

- ① Suggested region for power entrance at left. Entrance hole to be provided by installer.
- ② Purge Control Panel Class 1 Division 2
- ③ All installation egress from panel must be sealed (electrical conduit) for proper explosion proof installation.
- ④ Spark arrestor with calibration orifice is located behind the purge control unit and through the bottom of the enclosure.
- ⑤ Purge gas/compressed air inlet fitting here.

#### EXP2 Installation Notes

1. Any tubing, conduit, or fittings connected to the Pressurized Enclosure (PE) must conform to local codes for flammability ratings.
2. All egress into PE must be plugged and properly sealed to minimize leakage of purge air. Use hazardous location sealing fittings suitable for Class I locations within 18" (458mm) of enclosure.
3. The **EXP2** option is a continuous flow purge system and is calibrated to flow at 0.9 SCFM (1.5291 CMH). To minimize waste, plug and seal all openings and conduit.
4. The system is designed for use primarily with compressed air. The source of the compressed air must be from a non-classified area (see Purge Gas Supply Notes). Purge air must be clean, dry and free of flammable gases. When inert compressed gases are used (nitrogen, for example) the installer and facility manager must take suitable precautions on-site so that buildup of the inert gas does not present a health hazard. Where risk of asphyxiation exists, a warning label must be fitted to the Pressurized Enclosure (PE).
5. Adjustment of Purge System is not necessary. System is fully calibrated.
6. Connect to Purge System where indicated in the figure above. Connection port is 1/4" NPT female. Supply pressure must be regulated to 60–115 PSI (4-8 bar).

## Purge Gas Supply Notes

An alarm shall be provided to indicate failure of the protective gas supply to maintain the required pressure. Piping for the protective gas shall be protected against mechanical damage.

Where the compressor intake line passes through a classified location, it shall be constructed of noncombustible material, designed to prevent leakage of flammable gases, vapors, or dusts into the protective gas, and protected against mechanical damage and corrosion.

The electrical power for the protective gas supply (blower, compressor, etc.) shall be supplied either from a separate power source or from the protected enclosure power supply prior to any service disconnects of the protected enclosure. Any protected enclosure that can be isolated from the protective gas supply shall be equipped with an alarm. Where an alarm is used to indicate the loss of pressure in the cabinet:

- The alarm shall be located at a constantly attended location.
- The alarm actuator shall take its signal from the protected enclosure and shall not be installed between the enclosure and the protective gas supply.
- The alarm actuator shall be mechanical, pneumatic, or electrical.
- Electrical alarms and electrical alarm actuators shall be approved for the location in which they are installed.
- No valves shall be permitted between the alarm actuator and the enclosure.

## Intrinsically Safe (IS) Installation

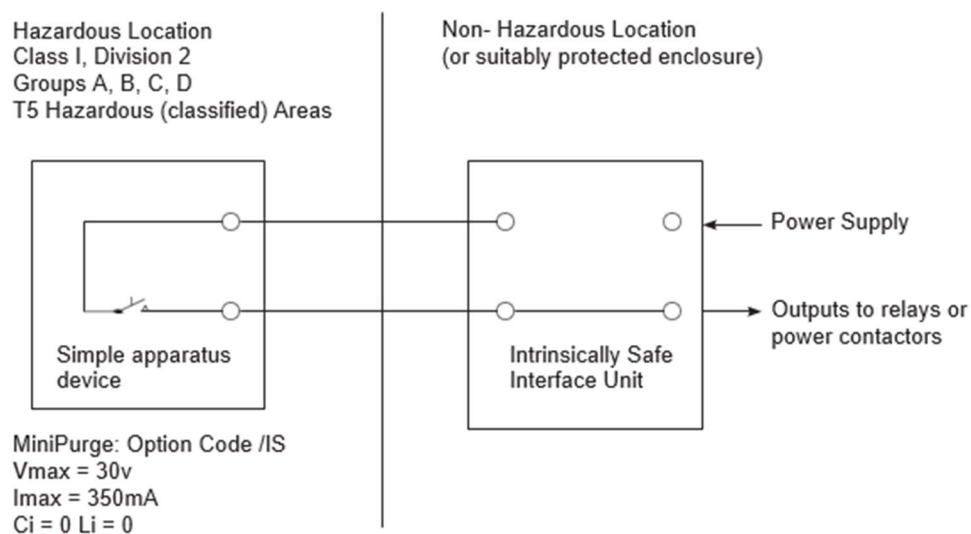

1. Electrical equipment connected to associated apparatus should not use or generate more than 250 volts.
2. Installation shall be in accordance with the manufacturer's instructions and the National Electrical Code (NFPA 70).
3. For guidance on Installation see ANSI/ISA RP12 .6 (Installation of IS Instrument System in Class I Hazardous Locations).
4.  $V_{oc}$  or  $V_t$  of associated apparatus is less than  $V_{max}$ .  
 $I_{sc}$  or  $I_T$  of associated apparatus is less than  $I_{max}$ .  
 $C_i$  plus capacitance of interconnecting cabling is less than  $C_a$  of the associated apparatus.  
 $L_i$  plus inductance of interconnecting cabling is less than  $L_a$  of the associated apparatus.
5. "Simple Apparatus" is a device that will not generate or store more than 1 .2V, 0,1A, 25mW or 20uJ.

## IS Installation continued...

All quarter turn latches in the door of the PE must be fully latched for proper operation. Power to the PE must be turned off before opening the enclosure.

**⚠ WARNING** This Pressurized Enclosure shall not be opened unless the area is known to be free of flammable materials or unless all devices within have been de-energized.

Power shall not be restored after the enclosure has been opened until the enclosure has been purged for allotted time (see table below). Time begins when pressure indicator turns green after the door of the enclosure has been closed and fully latched.

**⚠ WARNING** Ignition of potentially explosive gas/air mixtures may result if power is turned on before the allotted purge time!

Expo Technologies CF systems have a Minimum Pressure Sensor set to a pressure of at least 0.1" WC (0.25 bar). When the PE pressure is above this set point the sensor produces a positive Pressurized signal. This is displayed on the Red/ Green indicator located on the Purge System. This signal can be used to operate an electrical contact for a remote alarm. This signal may be supplied to the pressure operated switch suitable for Intrinsically Safe circuit in accordance. When the enclosure pressure falls below the set point of the sensor, the Pressurized signal is removed, and the Alarm conditions occurs. This alarm must be located where it can be readily observed according to NFPA496 requirements. **No valves may be fitted between the Expo Technologies system and the alarm switch.**

**⚠ WARNING** Never turn on the power without purging first, unless you have proved the interior of the PE is gas free and checked that the "Pressurized" indicator is green!

### Commissioning Test

Commissioning Continuous Flow Option EXP2 System:

1. Open the air or gas supply shutoff valve.
2. Adjust the Flow Control Valve (FCV) so that the enclosure pressure rises to the point where the "Pressurized" indicator turns green.
3. Lower the PE pressure until the Pressurized indicator turns Red.
4. Open the FCV again and set the PE pressure to a level somewhere between the Minimum Pressure Sensor set point and the RLV opening pressures. This working pressure is not critical. Enough pressure to keep the "Pressurized" indicator Green is sufficient.
5. On EXP2 Purge System the timing function is performed by the user. The user must ensure that the time delay between the indicator turning Yellow and the application of power to the PE is not less than the minimum time required to purge the PE as shown in the table below.

**Normal Operation:** Turn the air supply valve ON to start or OFF to stop the system. The user must close the Power Switch only after the enclosure has been pressurized and purged sufficiently to ensure that the interior of the enclosure is gas free. It is the operator's responsibility to shut off the power as soon as possible after a pressure failure.

PURGE TIME CHART - EXP2 Option for use with EXPO Mini Z Purge 1ZCF/bp/IS					
Model/Enclosure Group Size	Cubic Feet (Cubic Meters)	Volume Exchanges X 4	Orifice Size	Orifice No.	Purge Time (Minutes)
18kW	2 .78 (0 .08)	11 .12	0 .9	#2	13
25kW	3 .33 (0 .09)	13 .32	0 .9	#2	15

## Special Installation Maintenance

### **Routine Maintenance of the System (Every 6 months)**

#### **Recommended maintenance of the systems is as follows:**

Repeat Commissioning test at least every six months. The test includes checking the opening pressure of the Relief Valve, setting of the Minimum Pressure Sensor, the “Normal Working Pressure” of the enclosure. Test that the interlock and alarms function correctly.

Check the Relief Valve and any other Spark Arrestors. Remove any debris or corrosion or replace the Spark Arrestor. Check the condition of the air supply filter element. Clean or replace it as necessary.

### **Periodic Maintenance (Every 18-24 months)**

#### **At least every two years, the following additional checks are recommended:**

Apparatus (Heater, Purge Systems, Alarms etc.) is suitable for the Hazardous Location.

There are not unauthorized modifications.

The source of air is uncontaminated.

The interlock and alarms function correctly.

Approval labels are legible and undamaged.

Adequate spare parts are carried.

The action of pressure failure is correct.